

MUJI 無印良品

ANALOG ALARM CLOCK (Model No. MJ-AC2)

User Manual

This alarm clock can be set by rotating the frame of the clock.

- Thank you for your purchase.
- Read this User Manual beforehand to ensure correct use of the product.
- Retain this User Manual for future reference.

User Manual No. 8RE670AZ-EN3 (Y2111)

Accessories
AA manganese battery 1
This User Manual 1

Manufactured by
RYOHIN KEIKAKU CO., LTD.
4-26-3 Higashi-ikebukuro, Toshima-ku, Tokyo, JAPAN

Imported to EU by
MUJI Deutschland GmbH
Kurfuerstendamm 236, 10719 Berlin, Germany

Imported to Australia by
MUJI RETAIL(AUSTRALIA)PTY LTD
Level 5 90 William Street Melbourne, VIC 3000, Australia

 This product complies with all relevant and effective European Community legislations.



This symbol on the product, packaging, and/or accompanying document indicates that this product should not be disposed with normal household waste. This product shall be taken to the applicable collection point for recycling. The correct disposal of your old product will help prevent potential negative consequences for the environment and human health. For more information about recycling of this product, please contact the shop where you purchased the product, or your local authority.



This symbol on the battery or on the packaging indicates that the battery provided with this product shall not be treated as household waste. Please inform yourself about the local rules on separate collection of batteries. The correct disposal of batteries helps to prevent potentially negative consequences for the environment and human health.



CAUTION Indicates a hazard which may cause injury or product damage.



Do not insert the battery with ⊕ and ⊖ reversed.

Doing so may cause battery leakage or heating, resulting in malfunction or injury.



Do not use a rechargeable battery.

Doing so may cause malfunction.



Do not rotate the alarm bezel in the opposite direction.

Doing so may damage the product.



Do not use in places exposed to high temperatures and high humidity such as bath, sauna, or greenhouse.

Doing so may cause rust or damage.



Do not touch with wet hands.

Doing so may cause rust or damage.



Take the following precautions to prevent battery leakage or explosion.

- If the clock stops, either replace the battery with a new one or remove the battery.
- Replace the battery regularly once a year.



Remove the battery when not in use.

Leaving the battery in may cause leakage.



Do not subject to strong vibrations, falls, or other shocks.

Doing so may cause malfunction or damage.



Do not disassemble or modify.

Doing so may cause injury or malfunction.



Do not use in the following locations.

Doing so may cause degraded performance, deformation, deterioration, degradation, or malfunction.

- Locations exposed to direct sunlight.
- Locations close to open flame or heat from heating appliances.
- Locations with temperatures of -10 °C (14 °F) or lower or 50 °C (122 °F) or higher.
- Locations in the proximity of devices with strong magnetic field.
- Locations subject to strong vibration such as vehicles, ships, or construction sites.
- Dusty locations.
- Locations where gas is generated such as a swimming pool or hot spring.
- Locations where large quantities of oil are used, such as a kitchen.
- Locations where the product comes in contact with rubber or soft polyvinyl chloride for a long period of time. It may cause adhesion, deterioration, or colour transfer.



Do not use benzene, thinner, alcohol, or spray cleaners to clean.

Doing so may cause discolouration or dissolving of the product.

Safety Advice

Please read carefully and be sure to follow the instructions.

Graphic Symbol Explanations

 indicates prohibited actions.

 indicates compulsory actions.



WARNING Indicates a hazard which may cause death or serious injury.



Do not place small parts and battery within reach of small children.

Small children may accidentally swallow the product. If swallowed, immediately seek medical advice.



Do not touch the liquid leaked out of battery.

If it comes in contact with the eyes or skin, it may cause blindness, inflammation, or other injuries. In case of contact, rinse immediately well with tap water and seek medical advice.



- Do not short-circuit the battery.
- Do not disassemble the battery.
- Do not damage the battery.
- Do not charge the battery.
- Do not heat the battery.
- Do not expose the battery to fire.

Doing so may cause battery leakage, heating, or explosion.

Name and Function of Each Part

©Illustrations are for descriptive purposes only and may differ from the actual product.

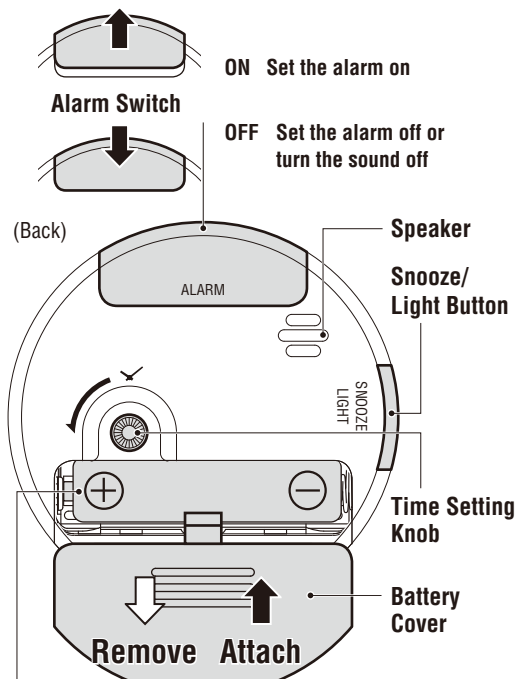
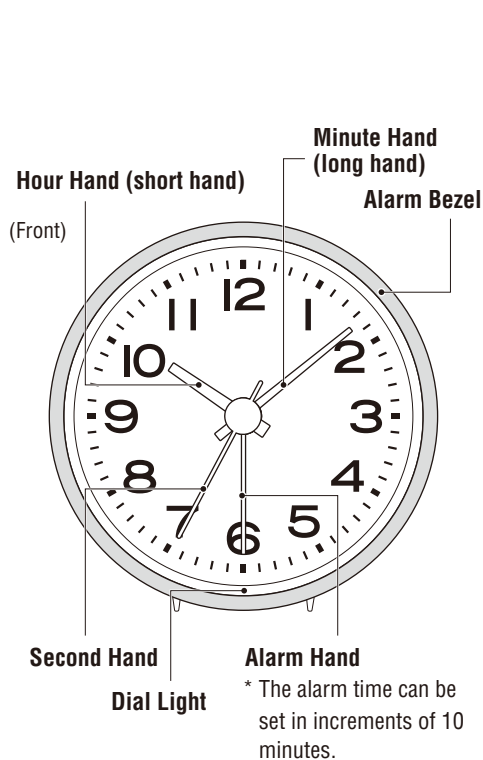

Opening/closing the battery cover

Remove
Slide the battery cover in the direction of ↓ while pressing the ≡ part.

Attach
Slide the battery cover in the direction of ↑.

AA battery

CAUTION

- Do not insert the battery with ⊕ and ⊖ reversed.
Doing so may cause battery leakage or heating, resulting in malfunction or injury.

Maintenance

- If the clock gets dirty, wipe with a soft cloth soaked in a mild detergent or soapy water, then wipe dry.

CAUTION

- Do not use benzene, thinner, alcohol, or spray cleaners to clean.
Doing so may cause discolouration or dissolving of the product.

Battery and Product Disposal

- Follow the rules and regulations of your local government.
- Dispose of the product and battery separately.

How to Use

1. Insert battery and set time

- Insert the battery into the battery holder as indicated by the polarity symbols ⊕ ⊖.
- Turn the time setting knob in the direction of the arrow to set the time.

2. Use the alarm

- Set the alarm time.
* See "How to set the alarm time".
Rotate the alarm bezel in the direction of the arrow to set the alarm hand to the desired alarm time.
- Set the alarm switch.
When it is turned ON, the alarm will sound at the set time. When it is turned OFF, the alarm will not sound.

Snooze function

If you press the snooze/light button while the alarm is sounding, the alarm stops and will start again after four minutes. This operation can be repeated for 25 to 55 minutes after the alarm starts sounding. To turn the snooze function OFF, turn the alarm switch OFF.

Alarm

- If the alarm switch is kept ON, the alarm will sound twice a day in the morning and afternoon at the set time. When not in use, turn it OFF.
- If the alarm is left sounding, it will continue to sound for 25 to 55 minutes.
- Due to the structure of the clock, the alarm will start sounding any time between 5 minutes before or after the set time.

Troubleshooting

Check the following items if the product does not appear to be working properly.

Problem	Cause and Solution
The hands are not moving. The hands stop moving.	<ul style="list-style-type: none"> The battery is inserted with ⊕ and ⊖ reversed. → Reinsert the battery in the correct direction. The battery is low or dead. → Replace it with a new one.
The alarm does not sound.	<ul style="list-style-type: none"> The alarm switch is turned OFF. → Turn the alarm switch ON.

How to set the alarm time

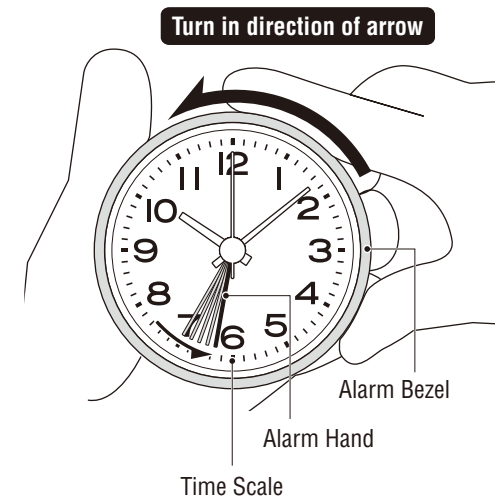

Example: Setting the alarm to 6:20

When you rotate the alarm bezel, the alarm hand will move accordingly. It clicks by 10 minutes. Set the alarm hand to 7 o'clock and move the alarm bezel toward 6 o'clock until it clicks four times.

CAUTION

- Do not turn the alarm bezel in the opposite direction of the arrow.
Doing so may damage the product.

Dial light

The dial light remains lit while the snooze/light button is pressed. The snooze/light button can also be used as the snooze button.

Specifications

Operating Environment : Temperature: between -10 °C and 50 °C (14 °F and 122 °F)
: Humidity: 85 %RH or lower
* Avoid condensation

Clock Function : Quartz
Alarm Sound : Digital sound (3 levels)
Alarm Accuracy : ±5 minutes of the set alarm time
Snooze : Pause of approx. 5 minutes
Time Accuracy : Average monthly difference ±20 seconds
When used at temperatures between 5 °C and 35 °C (41 °F and 95 °F)

Power Source : AA manganese battery
R6P (1.5 V) × 1

Battery Life : Approx. 1 year
When alarm is used for 30 sec. and light for 5 sec. a day

Dial light Dimensions : Wheat bulb
: W76 × D36 × H76 mm (W3.0 × D1.4 × H3.0 in)

Weight : Approx. 100 g (0.22 lb) (including battery)

Materials : Case: ABS resin
Windshield: PMMA resin